

### Features

- Ø4mm diameter
- Sn=0.6mm, 0.8mm, shielded
- 6-12VDC operating voltage
- Stainless steel housing case
- Namur output
- Cable version
- IP67 Protection

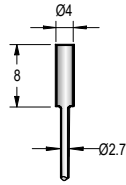

(Unit: mm)

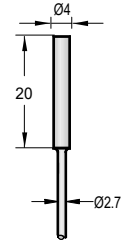

(Unit: mm)

Connection		2m Cable		2m Cable	
Mounting		Shielded	Shielded	Shielded	Shielded
Steel Case	Namur	N7DC04N0.6A	N7DC04N0.8A	N7DE04N0.6A	N7DE04N0.8A
	Namur with LED				
PBT Case	Namur				
	Namur with LED				
General Data					
Housing size	Ø4mm			Ø4mm	
Installation type	Shielded		Shielded		
Sensing distance(Sn: mm)	0.6mm		0.8mm		
Standard sensing object	Steel 4x4x1mm		Steel 4x4x1mm		
Effective sensing distance (Sr: mm)	90 ... 110% of Sn			90 ... 110% of Sn	
Assured operating distance(Sa: mm)	0 ... 80% of Sn			0 ... 80% of Sn	
Hysteresis	<15%			<15%	
Housing material	Stainless steel			Stainless steel	
Operating voltage	6 ... 12VDC			6 ... 12VDC	
Electrical Data					
Rated operating voltage	8VDC			8VDC	
Repeated accuracy	±10%			±10%	
Ripple	/			/	
No load current	>2.2mA(Off), <1.1mA(On)			>2.2mA(Off), <1.1mA(On)	
Max. Load current	/			/	
Leakage current	/			/	
Voltage drop	/	/	/	/	/
Switching frequency	2000Hz		2000Hz		
Response time	0.05ms/0.05ms		0.05ms/0.05ms		
Rated insulation voltage	75VDC			75VDC	
Operating temperature	-25°C ... +70°C			-25°C ... +70°C	
Storage temperature	-40°C ... +80°C			-40°C ... +80°C	
Temperature drift	<2%			<2%	
Power indicator	No			No	
Function indicator	No			No	
Reverse polarity protection	/			/	
Short-circuit protection	/			/	
Overload trip point	/			/	
Correction factors	Fe37 steel=1/stainless steel approx. 0.85/brass approx. 0.5/ Al. Approx. 0.45/ copper approx. 0.4			Fe37 steel=1/stainless steel approx. 0.85/brass approx. 0.5/ Al. Approx. 0.45/ copper approx. 0.4	
Mechanical Data					
Sensing surface material	POM			POM	
Protection	IP67			IP67	
Shock rating	Shock, half-sinus, 30gn, 11ms			Shock, half-sinus, 30gn, 11ms	
Vibration rating	55Hz, 1mm ampl., 3x30min.			55Hz, 1mm ampl., 3x30min.	
EMC	IEC 60947-5-2 EN 55501: Class B			IEC 60947-5-2 EN 55501: Class B	
Accessory	/			/	
Connection	PVC cable (Ø2.7 2x0.15mm²)			PVC cable (Ø2.7 2x0.15mm²)	
Weight	Approx. 25g			Approx. 25g	

### Features

- M5mm diameter
- Sn=0.6mm,0.8mm,shielded
- 6-12VDC operating voltage
- Stainless steel housing case
- Namur output
- Cable version
- IP67 Protection

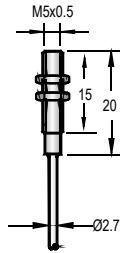

(Unit: mm)

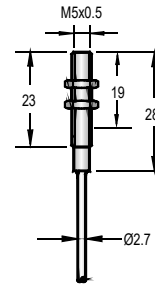

(Unit: mm)



Connection		2m Cable		2m Cable	
Mounting		Shielded	Shielded	Shielded	Shielded
Steel Case	Namur	N7CC05N0.6A	N7CC05N0.8A	N7CE05N0.6A	N7CE05N0.8A
	Namur with LED				
PBT Case	Namur				
	Namur with LED				
General Data					
Housing size	M5mm			M5mm	
Installation type	Shielded		Shielded		
Sensing distance(Sn: mm)	0.6mm		0.8mm		
Standard sensing object	Steel 5x5x1mm		Steel 5x5x1mm		
Effective sensing distance (Sr: mm)	90 ... 110% of Sn			90 ... 110% of Sn	
Assured operating distance(Sa: mm)	0 ... 80% of Sn			0 ... 80% of Sn	
Hysteresis	<15%			<15%	
Housing material	Stainless steel			Stainless steel	
Operating voltage	6 ... 12VDC			6 ... 12VDC	
Electrical Data					
Rated operating voltage	8VDC			8VDC	
Repeated accuracy	±10%			±10%	
Ripple	/			/	
No load current	>2.2mA(Off), <1.1mA(On)			>2.2mA(Off), <1.1mA(On)	
Max. Load current	/			/	
Leakage current	/			/	
Voltage drop	/	/	/	/	/
Switching frequency	2000Hz		2000Hz		
Response time	0.05ms/0.05ms		0.05ms/0.05ms		
Rated insulation voltage	75VDC			75VDC	
Operating temperature	-25°C ... +70°C			-25°C ... +70°C	
Storage temperature	-40°C ... +80°C			-40°C ... +80°C	
Temperature drift	<2%			<2%	
Power indicator	No			No	
Function indicator	No			No	
Reverse polarity protection	/			/	
Short-circuit protection	/			/	
Overload trip point	/			/	
Correction factors	Fe37 steel=1/stainless steel approx. 0.85/brass approx. 0.5/ Al. Approx. 0.45/ copper approx. 0.4			Fe37 steel=1/stainless steel approx. 0.85/brass approx. 0.5/ Al. Approx. 0.45/ copper approx. 0.4	
Mechanical Data					
Sensing surface material	POM			POM	
Protection	IP67			IP67	
Shock rating	Shock, half-sinus, 30gn, 11ms			Shock, half-sinus, 30gn, 11ms	
Vibration rating	55Hz, 1mm ampl., 3x30min.			55Hz, 1mm ampl., 3x30min.	
EMC	IEC 60947-5-2 EN 55501: Class B			IEC 60947-5-2 EN 55501: Class B	
Accessory	2 nuts			2 nuts	
Connection	PVC cable (Ø2.7 2x0.15mm²)			PVC cable (Ø2.7 2x0.15mm²)	
Weight	Approx. 25g			Approx. 25g	

### Features

- Ø6.5mm diameter
- Sn=0.8mm, 1mm, shielded  
1mm, 2mm, non-shielded
- 6-12VDC operating voltage
- Stainless steel housing case
- Namur output
- Cable version
- IP67 Protection

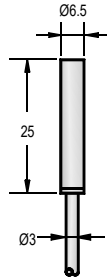

(Unit: mm)

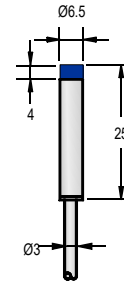

(Unit: mm)



Connection		2m Cable		2m Cable	
Mounting		Shielded	Shielded	Shielded	Shielded
Steel Case	Namur	N7DE6.5N0.8A	N7DE6.5N01A	N7DF6.5N01A	N7DF6.5N02A
	Namur with LED				
PBT Case	Namur				
	Namur with LED				
General Data					
Housing size		Ø6.5mm		Ø6.5mm	
Installation type		Shielded	Shielded	Non-shielded	Non-shielded
Sensing distance(Sn: mm)		0.8mm	1mm	1mm	2mm
Standard sensing object		Steel 6.5x6.5x1mm	Steel 6.5x6.5x1mm	Steel 6.5x6.5x1mm	Steel 6.5x6.5x1mm
Effective sensing distance (Sr: mm)		90 ... 110% of Sn		90 ... 110% of Sn	
Assured operating distance(Sa: mm)		0 ... 80% of Sn		0 ... 80% of Sn	
Hysteresis		<15%		<15%	
Housing material		Stainless steel		Stainless steel	
Operating voltage		6 ... 12VDC		6 ... 12VDC	
Electrical Data					
Rated operating voltage		8VDC		8VDC	
Repeated accuracy		±10%		±10%	
Ripple		/		/	
No load current		>2.2mA(Off), <1.1mA(On)		>2.2mA(Off), <1.1mA(On)	
Max. Load current		/		/	
Leakage current		/		/	
Voltage drop		/	/	/	/
Switching frequency		2000Hz	2000Hz	2000Hz	2000Hz
Response time		0.05ms/0.05ms	0.05ms/0.05ms	0.05ms/0.05ms	0.05ms/0.05ms
Rated insulation voltage		75VDC		75VDC	
Operating temperature		-25°C ... +70°C		-25°C ... +70°C	
Storage temperature		-40°C ... +80°C		-40°C ... +80°C	
Temperature drift		<2%		<2%	
Power indicator		No		No	
Function indicator		No		No	
Reverse polarity protection		/		/	
Short-circuit protection		/		/	
Overload trip point		/		/	
Correction factors		Fe37 steel=1/stainless steel approx. 0.85/brass approx. 0.5/ Al. Approx. 0.45/ copper approx. 0.4		Fe37 steel=1/stainless steel approx. 0.85/brass approx. 0.5/ Al. Approx. 0.45/ copper approx. 0.4	
Mechanical Data					
Sensing surface material		PBT		PBT	
Protection		IP67		IP67	
Shock rating		Shock, half-sinus, 30gn, 11ms		Shock, half-sinus, 30gn, 11ms	
Vibration rating		55Hz, 1mm ampl., 3x30min.		55Hz, 1mm ampl., 3x30min.	
EMC		IEC 60947-5-2 EN 55501: Class B		IEC 60947-5-2 EN 55501: Class B	
Accessory		/		/	
Connection		PVC cable (Ø3 2x0.15mm²)		PVC cable (Ø3 2x0.15mm²)	
Weight		Approx. 25g		Approx. 25g	

### Features

- M8mm diameter
- Sn=1mm, shielded  
2mm, non-shielded
- 6-12VDC operating voltage
- Stainless steel housing case
- Namur output
- Cable version
- IP67 Protection

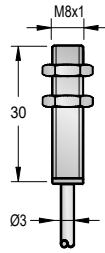

(Unit: mm)

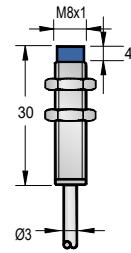

(Unit: mm)



Connection		2m Cable		2m Cable	
Mounting		Shielded		Non-shielded	
Steel Case	Namur	N7CE08N01A		N7CF08N02A	
	Namur with LED				
PBT Case	Namur				
	Namur with LED				
General Data					
Housing size		M8mm		M8mm	
Installation type		Shielded		Non-shielded	
Sensing distance(Sn: mm)		1mm		2mm	
Standard sensing object		Steel 8x8x1mm		Steel 8x8x1mm	
Effective sensing distance (Sr: mm)		90 ... 110% of Sn		90 ... 110% of Sn	
Assured operating distance(Sa: mm)		0 ... 80% of Sn		0 ... 80% of Sn	
Hysteresis		<15%		<15%	
Housing material		Stainless steel		Stainless steel	
Operating voltage		6 ... 12VDC		6 ... 12VDC	
Electrical Data					
Rated operating voltage		8VDC		8VDC	
Repeated accuracy		±10%		±10%	
Ripple		/		/	
No load current		>2.2mA(Off), <1.1mA(On)		>2.2mA(Off), <1.1mA(On)	
Max. Load current		/		/	
Leakage current		/		/	
Voltage drop		/		/	
Switching frequency		2000Hz		2000Hz	
Response time		0.05ms/0.05ms		0.05ms/0.05ms	
Rated insulation voltage		75VDC		75VDC	
Operating temperature		-25°C ... +70°C		-25°C ... +70°C	
Storage temperature		-40°C ... +80°C		-40°C ... +80°C	
Temperature drift		<2%		<2%	
Power indicator		No		No	
Function indicator		No		No	
Reverse polarity protection		/		/	
Short-circuit protection		/		/	
Overload trip point		/		/	
Correction factors		Fe37 steel=1/stainless steel approx. 0.85/brass approx. 0.5/ Al. Approx. 0.45/ copper approx. 0.4		Fe37 steel=1/stainless steel approx. 0.85/brass approx. 0.5/ Al. Approx. 0.45/ copper approx. 0.4	
Mechanical Data					
Sensing surface material		PBT		PBT	
Protection		IP67		IP67	
Shock rating		Shock, half-sinus, 30gn, 11ms		Shock, half-sinus, 30gn, 11ms	
Vibration rating		55Hz, 1mm ampl., 3x30min.		55Hz, 1mm ampl., 3x30min.	
EMC		IEC 60947-5-2 EN 55501: Class B		IEC 60947-5-2 EN 55501: Class B	
Accessory		2 nuts		2 nuts	
Connection		PVC cable (Ø3 2x0.15mm²)		PVC cable (Ø3 2x0.15mm²)	
Weight		Approx. 34g		Approx. 34g	

### Features

- M12mm diameter
- Sn=2mm, shielded  
4mm, non-shielded
- 6-12VDC operating voltage
- Stainless steel housing case
- Nickel plated brass housing case
- Namur output
- Namur output with LED
- Cable version
- IP67 Protection

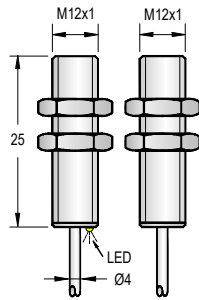

(Unit: mm)

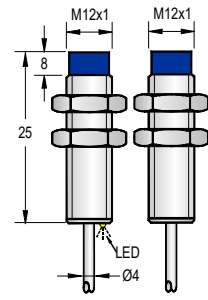

(Unit: mm)



Connection		2m Cable		2m Cable	
Mounting		Shielded		Non-shielded	
Steel Case	Namur	N7CE12N02A		N7CF12N04A	
	Namur with LED	N7CE12G02A		N7CF12G04A	
Brass Case	Namur	N7AE12N02A		N7AF12N04A	
	Namur with LED	N7AE12G02A		N7AF12G04A	
General Data					
Housing size		M12mm		M12mm	
Installation type		Shielded		Non-shielded	
Sensing distance(Sn: mm)		2mm		4mm	
Standard sensing object		Steel 12x12x1mm		Steel 12x12x1mm	
Effective sensing distance (Sr: mm)		90 ... 110% of Sn		90 ... 110% of Sn	
Assured operating distance(Sa: mm)		0 ... 80% of Sn		0 ... 80% of Sn	
Hysteresis		<15%		<15%	
Housing material		Stainless steel,Nickel plated brass		Stainless steel,Nickel plated brass	
Operating voltage		6 ... 12VDC		6 ... 12VDC	
Electrical Data					
Rated operating voltage		8VDC		8VDC	
Repeated accuracy		±10%		±10%	
Ripple		/		/	
No load current		>2.2mA(Off), <1.1mA(On)		>2.2mA(Off), <1.1mA(On)	
Max. Load current		/		/	
Leakage current		/		/	
Voltage drop		/		/	
Switching frequency		1000Hz		500Hz	
Response time		0.1ms/0.1ms		0.2ms/0.2ms	
Rated insulation voltage		75VDC		75VDC	
Operating temperature		-25°C ... +70°C		-25°C ... +70°C	
Storage temperature		-40°C ... +80°C		-40°C ... +80°C	
Temperature drift		<2%		<2%	
Power indicator		No		No	
Function indicator		No/Yes		No/Yes	
Reverse polarity protection		/		/	
Short-circuit protection		/		/	
Overload trip point		/		/	
Correction factors		Fe37 steel=1/stainless steel approx. 0.85/brass approx. 0.5/ Al. Approx. 0.45/ copper approx. 0.4		Fe37 steel=1/stainless steel approx. 0.85/brass approx. 0.5/ Al. Approx. 0.45/ copper approx. 0.4	
Mechanical Data					
Sensing surface material		PBT		PBT	
Protection		IP67		IP67	
Shock rating		Shock, half-sinus, 30gn, 11ms		Shock, half-sinus, 30gn, 11ms	
Vibration rating		55Hz, 1mm ampl., 3x30min.		55Hz, 1mm ampl., 3x30min.	
EMC		IEC 60947-5-2 EN 55501: Class B		IEC 60947-5-2 EN 55501: Class B	
Accessory		2 nuts		2 nuts	
Connection		PVC cable (Ø4 2x0.34mm²)		PVC cable (Ø4 2x0.34mm²)	
Weight		Approx. 34g		Approx. 34g	

### Features

- M18mm diameter
- Sn=5mm, shielded
- 8mm, non-shielded
- 6-12VDC operating voltage
- Stainless steel housing case
- Nickel plated brass housing case
- Namur output
- Namur output with LED
- Cable version
- IP67 Protection

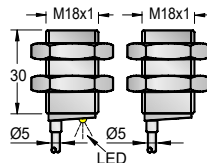

(Unit: mm)

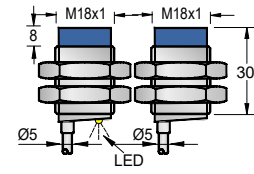

(Unit: mm)



Connection		2m Cable		2m Cable	
Mounting		Shielded		Non-shielded	
Steel Case	Namur	N7CE18N05A		N7CF18N08A	
	Namur with LED	N7CE18G05A		N7CF18G08A	
Brass Case	Namur	N7AE18N05A		N7AF18N08A	
	Namur with LED	N7AE18G05A		N7AF18G08A	
General Data					
Housing size		M18mm		M18mm	
Installation type		Shielded		Non-shielded	
Sensing distance(Sn: mm)		5mm		8mm	
Standard sensing object		Steel 18x18x1mm		Steel 24x24x1mm	
Effective sensing distance (Sr: mm)		90 ... 110% of Sn		90 ... 110% of Sn	
Assured operating distance(Sa: mm)		0 ... 80% of Sn		0 ... 80% of Sn	
Hysteresis		<15%		<15%	
Housing material		Stainless steel/Nickel plated brass		Stainless steel/Nickel plated brass	
Operating voltage		6 ... 12VDC		6 ... 12VDC	
Electrical Data					
Rated operating voltage		8VDC		8VDC	
Repeated accuracy		±10%		±10%	
Ripple		/		/	
No load current		>2.2mA(Off), <1.1mA(On)		>2.2mA(Off), <1.1mA(On)	
Max. Load current		/		/	
Leakage current		/		/	
Voltage drop		/		/	
Switching frequency		500Hz		300Hz	
Response time		0.2ms/0.2ms		0.5ms/0.5ms	
Rated insulation voltage		75VDC		75VDC	
Operating temperature		-25°C ... +70°C		-25°C ... +70°C	
Storage temperature		-40°C ... +80°C		-40°C ... +80°C	
Temperature drift		<2%		<2%	
Power indicator		No		No	
Function indicator		No/Yes		No/Yes	
Reverse polarity protection		/		/	
Short-circuit protection		/		/	
Overload trip point		/		/	
Correction factors		Fe37 steel=1/stainless steel approx. 0.85/brass approx. 0.5/ Al. Approx. 0.45/ copper approx. 0.4		Fe37 steel=1/stainless steel approx. 0.85/brass approx. 0.5/ Al. Approx. 0.45/ copper approx. 0.4	
Mechanical Data					
Sensing surface material		PBT		PBT	
Protection		IP67		IP67	
Shock rating		Shock, half-sinus, 30gn, 11ms		Shock, half-sinus, 30gn, 11ms	
Vibration rating		55Hz, 1mm ampl., 3x30min.		55Hz, 1mm ampl., 3x30min.	
EMC		IEC 60947-5-2 EN 55501: Class B		IEC 60947-5-2 EN 55501: Class B	
Accessory		2 nuts		2 nuts	
Connection		PVC cable (Ø5 2x0.34mm²)		PVC cable (Ø5 2x0.34mm²)	
Weight		Approx. 126g		Approx. 126g	

### Features

- M30mm diameter
- Sn=10mm, shielded  
15mm, non-shielded
- 6-12VDC operating voltage
- Stainless steel housing case
- Nickel plated brass housing case
- Namur output
- Namur output with LED
- Cable version
- IP67 Protection

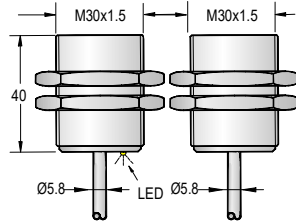

(Unit: mm)

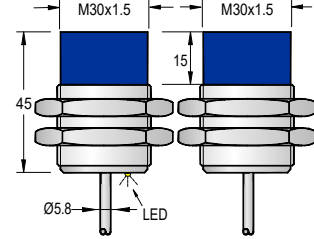

(Unit: mm)



Connection		2m Cable		2m Cable	
Mounting		Shielded		Non-shielded	
Steel Case	Namur	N7CE30N10A		N7CF30N15A	
	Namur with LED	N7CE30G10A		N7CF30G15A	
Brass Case	Namur	N7AE30N10A		N7AF30N15A	
	Namur with LED	N7AE30G10A		N7AF30G15A	
General Data					
Housing size		M30mm		M30mm	
Installation type		Shielded		Non-shielded	
Sensing distance(Sn: mm)		10mm		15mm	
Standard sensing object		Steel 30x30x1mm		Steel 45x45x1mm	
Effective sensing distance (Sr: mm)		90 ... 110% of Sn		90 ... 110% of Sn	
Assured operating distance(Sa: mm)		0 ... 80% of Sn		0 ... 80% of Sn	
Hysteresis		<15%		<15%	
Housing material		Stainless steel/Nickel plated brass		Stainless steel/Nickel plated brass	
Operating voltage		6 ... 12VDC		6 ... 12VDC	
Electrical Data					
Rated operating voltage		8VDC		8VDC	
Repeated accuracy		±10%		±10%	
Ripple		/		/	
No load current		>2.2mA(Off), <1.1mA(On)		>2.2mA(Off), <1.1mA(On)	
Max. Load current		/		/	
Leakage current		/		/	
Voltage drop		/		/	
Switching frequency		300Hz		100Hz	
Response time		0.5ms/0.5ms		1ms/1ms	
Rated insulation voltage		75VDC		75VDC	
Operating temperature		-25°C ... +70°C		-25°C ... +70°C	
Storage temperature		-40°C ... +80°C		-40°C ... +80°C	
Temperature drift		<2%		<2%	
Power indicator		No		No	
Function indicator		No/Yes		No/Yes	
Reverse polarity protection		/		/	
Short-circuit protection		/		/	
Overload trip point		/		/	
Correction factors		Fe37 steel=1/stainless steel approx. 0.85/brass approx. 0.5/ Al. Approx. 0.45/ copper approx. 0.4		Fe37 steel=1/stainless steel approx. 0.85/brass approx. 0.5/ Al. Approx. 0.45/ copper approx. 0.4	
Mechanical Data					
Sensing surface material		PBT		PBT	
Protection		IP67		IP67	
Shock rating		Shock, half-sinus, 30gn, 11ms		Shock, half-sinus, 30gn, 11ms	
Vibration rating		55Hz, 1mm ampl., 3x30min.		55Hz, 1mm ampl., 3x30min.	
EMC		IEC 60947-5-2 EN 55501: Class B		IEC 60947-5-2 EN 55501: Class B	
Accessory		2 nuts		2 nuts	
Connection		PVC cable (Ø5.8 2x0.5mm²)		PVC cable (Ø5.8 2x0.5mm²)	
Weight		Approx. 185g		Approx. 185g	

- Q16x28x10mm diameter
- Sn=1mm, shielded  
2mm, non-shielded
- 6-12VDC operating voltage
- PBT Resin housing case
- Namur output
- Cable version
- IP67 Protection

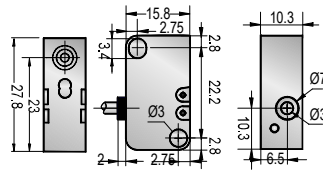

(Unit: mm)

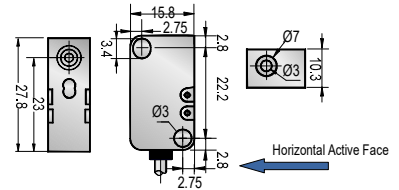
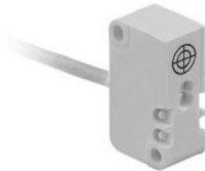

(Unit: mm)



Connection		2m Cable		2m Cable	
Mounting		Shielded	Non-shielded	Shielded	Non-shielded
Steel Case	Namur				
	Namur with LED				
PBT Case	Namur	N7EE16N01A	N7EF16N02A	N7EK16N01A	N7EX16N02A
	Namur with LED				
General Data					
Housing size	Q 16x28x10mm		Q 16x28x10mm		
Installation type	Shielded	Non-shielded	Shielded	Non-shielded	
Sensing distance(Sn: mm)	1mm	2mm	1mm	2mm	
Standard sensing object	Steel 16x16x1mm	Steel 16x16x1mm	Steel 16x16x1mm	Steel 16x16x1mm	
Effective sensing distance (Sr: mm)	90 ... 110% of Sn		90 ... 110% of Sn		
Assured operating distance(Sa: mm)	0 ... 80% of Sn		0 ... 80% of Sn		
Hysteresis	<15%		<15%		
Housing material	PBT Resin		PBT Resin		
Operating voltage	6 ... 12VDC		6 ... 12VDC		
Electrical Data					
Rated operating voltage	8VDC		8VDC		
Repeated accuracy	±10%		±10%		
Ripple	/		/		
No load current	>2.2mA(Off), <1.1mA(On)		>2.2mA(Off), <1.1mA(On)		
Max. Load current	/		/		
Leakage current	/		/		
Voltage drop	/	/	/	/	
Switching frequency	2000Hz	1000Hz	2000Hz	1000Hz	
Response time	0.05ms/0.05ms	0.1ms/0.1ms	0.05ms/0.05ms	0.1ms/0.1ms	
Rated insulation voltage	75VDC		75VDC		
Operating temperature	-25°C ... +70°C		-25°C ... +70°C		
Storage temperature	-40°C ... +80°C		-40°C ... +80°C		
Temperature drift	<2%		<2%		
Power indicator	No		No		
Function indicator	No		No		
Reverse polarity protection	/		/		
Short-circuit protection	/		/		
Overload trip point	/		/		
Correction factors	Fe37 steel=1/stainless steel approx. 0.85/brass approx. 0.5/ Al. Approx. 0.45/ copper approx. 0.4		Fe37 steel=1/stainless steel approx. 0.85/brass approx. 0.5/ Al. Approx. 0.45/ copper approx. 0.4		
Mechanical Data					
Sensing surface material	PBT		PBT		
Protection	IP67		IP67		
Shock rating	Shock, half-sinus, 30gn, 11ms		Shock, half-sinus, 30gn, 11ms		
Vibration rating	55Hz, 1mm ampl., 3x30min.		55Hz, 1mm ampl., 3x30min.		
EMC	IEC 60947-5-2 EN 55501: Class B		IEC 60947-5-2 EN 55501: Class B		
Accessory	/		/		
Connection	PVC cable (Ø3 2x0.15mm²)		PVC cable (Ø3 2x0.15mm²)		
Weight	Approx. 55g		Approx. 55g		